

## 2MEGAPIXEL NETWORK COVERT CAMERA

VHi



## → KEY FEATURES

- 1/3" 2Megapixel APTINA CMOS Image Sensor
- Megapixel Pinhole Lens f=3.7mm (78°)
- Multi Streaming of H.264 and MJPEG
- Supports Image Resolution up to 1920x1080 (FHD)
- Full HD (1920x1080 : 1080p) 30fps
- Supports CBR and CVBR Mode
- Controllable Frame Rate
- 2D+3D DNR (Digital Noise Reduction)
- WDR (Wide Dynamic Range)
- Smart IR
- Defog
- Privacy Masking up to 8 Areas
- 2 Way Audio
- Digital Zoom
- DC 12V and IEEE 802.3af PoE
- ONVIF Support
- Includes Windows Based IP Installer and License-free 16 Channel NVR Software

## → DIMENSIONS

Unit : mm

Main unit (Server)

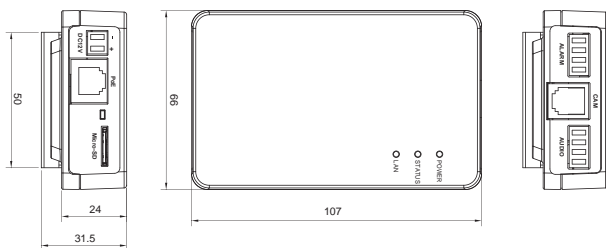

Sensor unit (Camera)

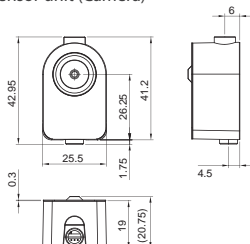

## → SPECIFICATIONS

| VHi                   |                   |  |
|-----------------------|-------------------|--|
| General               | CPU               | 32-bit ARM9 RISC CPU up to 432MHz  |
|                       | Flash             | 128 Mbyte  |
|                       | SDRAM             | 128 Mbyte  |
| Camera                | Image Sensor      | 1/3" 2Megapixel APTINA CMOS  |
|                       | Total Pixels      | 2034(H) x 1536(V)  |
|                       | Effective Pixels  | 1920(H) x 1080(V)  |
|                       | S/N Ratio         | More than 50dB   |
|                       | Min. Illumination | 0.2Lux   |
|                       | Day & Night       | Auto (AGC D/N)   |
|                       | Lens              | Megapixel Pinhole Lens f=3.7mm   |
| Video                 | Compression       | H.264 High Profile@4.0, MJPEG - Image quality : 3 steps                          |
|                       | Resolution        | Up to 1920x1080 (FHD)  |
|                       | Frame Rate        | H.264 Up to 30fps with 1920x1080<br>MJPEG Up to 30fps with VGA resolution        |
|                       | Streaming         | Support multi stream with H.264, MJPEG, Adjustable frame rate, CVBR/CBR in H.264 |
|                       | Pan / Tilt / Zoom | Digital PTZ  |
|                       | Image Setting     | Day & Night  |
|                       |                   | Auto white balance   |
|                       |                   | Auto exposure  |
|                       |                   | Privacy mask   |
|                       |                   | WDR (Low / Middle / High)  |
|                       |                   | Defog (On / Off), Smart IR (Off / 0~15)  |
|                       |                   | 3DNR (On / Off)  |
|                       |                   | Effect - Color, Sharpness, Mirror/V-Flip, etc.                                   |
| Audio                 | Compression       | Two way  |
|                       | Streaming         | G.711  |
| Network               | Security          | Password protection, User access log, HTTPS encryption                           |
|                       | Protocol          | HTTP, HTTPS, FTP, SMTP, UPnP, DNS, DDNS, NTP, RTSP, RTP, TCP, UDP, ICMP, DHCP    |
|                       | Intelligent Video | Motion detection up to 1920x1080 with 4x3 blocks                                 |
|                       | Alarm Events      | File upload via FTP, E-mail, Notification via email, FTP and TCP                 |
|                       | Video Buffer      | 5MB Pre-alarm and 180sec. (Max.) Post-alarm                                      |
|                       | F/W Upgrade       | Remote upgrade via network   |
|                       | API               | CGI interface document, ActiveX interface [ocx (dll) + document]                 |
|                       | Software          | NVR C/S (16channel), IP Installer (Windows only)                                 |
| Storage               |                   | Micro SD slot  |
| LED's                 |                   | Power, Network status, Network link  |
| Package Contents      |                   | Network camera, User manual, External power adaptor (optional), Software CD      |
| Power Source          |                   | DC 12V / 1.5A, PoE (Power over Ethernet) : 802.3af                               |
| Power Consumption     |                   | Max. 4.5W  |
| Operating Temperature |                   | -10°C ~ 50°C (14°F ~ 122°F)  |
| Storage Temperature   |                   | -20°C ~ 60°C (-4°F ~ 140°F)  |
| Dimension             |                   | 66(W) x 107(H) x 31.5(D)mm   |
| Weight                |                   | Appx. 110g (Server only)   |

\* Design and specification are subject to change without notice.